

From: [REDACTED]
To: [Hynet CO2 Pipeline](#)
Cc: [REDACTED]
Subject: HyNet Information for ISH3: Green wedge and Alltami Brook
Date: 03 August 2023 11:39:29
Attachments: [image001.jpg](#)
[Alltami Brook and Green Wedge.pdf](#)

Good morning,

I thought it might be helpful to send a map showing the Flintshire's Green Wedge boundary in relation to the Alltami Brook as I note that this is a matter which the ExA wish to raise on Wednesday 9th August.

It is my understanding that the Alltami Brook does not fall within the Green Wedge and therefore the proposed above ground encased crossing would not lie within the Green Wedge either. I will be able to confirm this verbally at the Hearing on 9th August should the ExA wish to discuss it.

Cofion Cynnes / Kind Regards
Hannah Parish

Rheolwr Cynllunio Mwynau a Gwastraff | Minerals and Waste Planning Manager
Gwasanaeth Cynllunio Mwynau a Gwastraff Gogledd Cymru | North Wales Minerals and Waste Planning Service
Cynllunio, Amgylchedd ac Economi | Planning, Environment and Economy
Cyngor Sir y Fflint | Flintshire County Council



Ffôn | Tel | [REDACTED]
Ffôn Symudol | Mobile [REDACTED]
Ebost | Email | [REDACTED] [@siryfflint.gov.uk](mailto:[REDACTED]@siryfflint.gov.uk) |
[REDACTED] [@flintshire.gov.uk](mailto:[REDACTED]@flintshire.gov.uk)
Ebost | Email | mineralsandwaste@siryfflint.gov.uk |
mineralsandwaste@flintshire.gov.uk

<http://www.siryfflint.gov.uk> | <http://www.flintshire.gov.uk>
<http://www.twitter.com/csyfflint> | <http://www.twitter.com/flintshirecc>

Cyn argraffu yr e bôst hon, ystyriwch eich cyfrifoldeb amgylcheddol os gwelwch yn dda.
Please consider your environmental responsibility before printing this email.



Together keeping Flintshire safe email signature

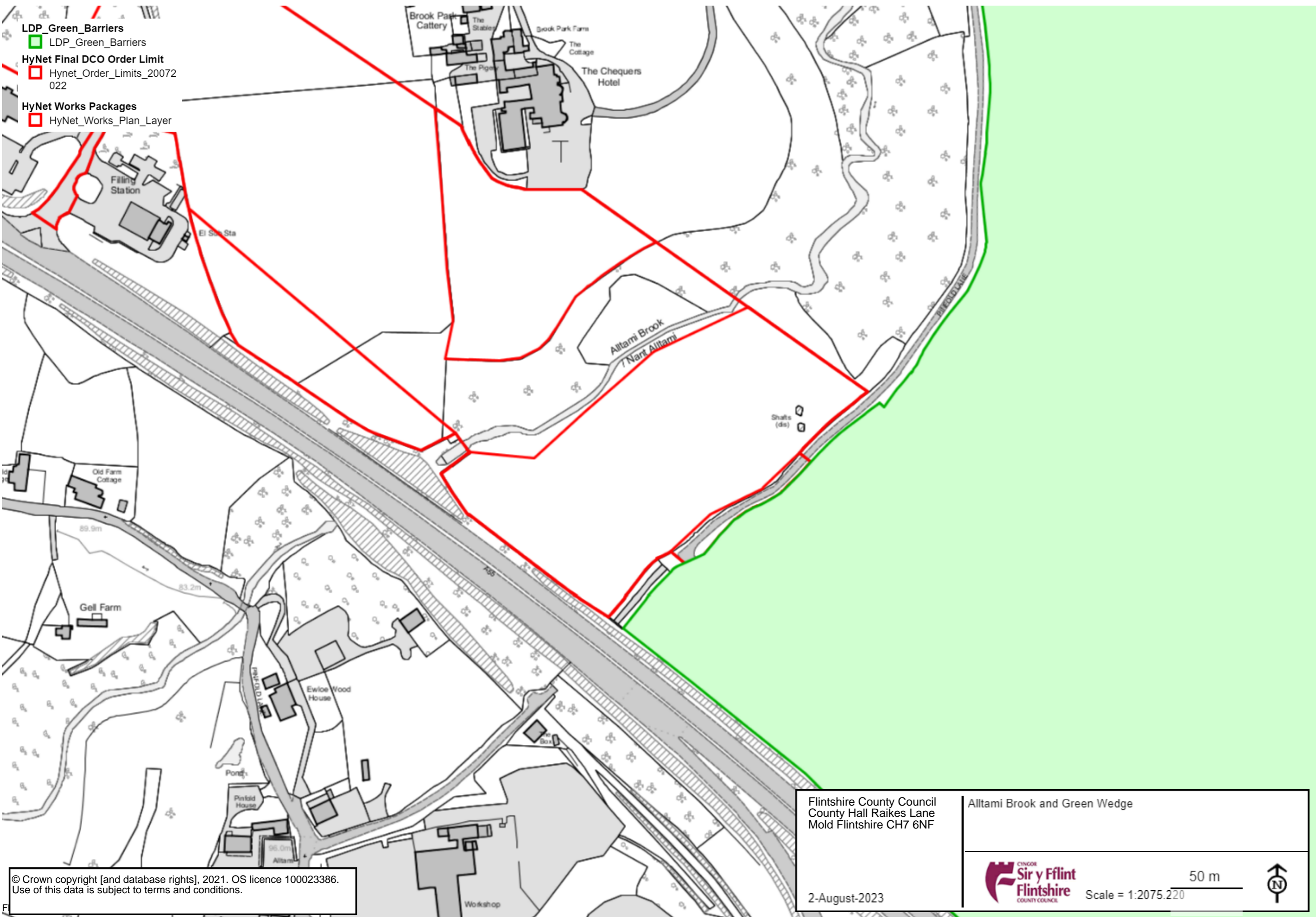

- LDP_Green_Barriers**
 -  LDP_Green_Barriers
- HyNet Final DCO Order Limit**
 -  Hynet_Order_Limits_20072 022
- HyNet Works Packages**
 -  HyNet_Works_Plan_Layer



© Crown copyright [and database rights], 2021. OS licence 100023386. Use of this data is subject to terms and conditions.

Flintshire County Council County Hall Raikes Lane Mold Flintshire CH7 6NF	Alltami Brook and Green Wedge
2-August-2023	   Scale = 1:2075.220